



YOUR EXCLUSIVE HUMMER ACCESSORY SOURCE

234 Venture Street Suite 101, San Marcos Ca 92078

Phone: 760-510-1298 Fax: 760-874-2973

# H2 TIRE CARRIER INSTRUCTIONS

## Product Information:

Thank you for your recent purchase of your new Tire Carrier. You now own the finest Tire Carrier on the market.

**IMPORTANT:** To ensure proper function and safety, you **MUST** completely push latch in until it clicks and latches closed. Note: When properly closed, latch handle will remain perfectly flush in housing with release button/lock exposed. Failure to do so will void warranty and possibly cause injury. Predator Motorsports will not be liable for misuse.

The entire carrier pivots on a proven bearing system rated at 2000 lbs, which will guarantee smooth operation. This system will need to be greased and inspected every 3,000 miles.

Incorporated into the design is a drop-down feature, which aids in relocating your tire to the ground in the event of a flat tire. Simply lift up on the carrier arm to relieve pressure on the Stainless Push Pin and pull the pin. Slowly drop carrier arm to the ground. When locating carrier arm back into the vertical position care must be taken not to move the support rod. If the support rod is moved you will need to take several moments to relocate the support rod end back into the original position for proper alignment of the pin. If your carrier is equipped with the optional Opening Assist, the hydraulic ram **MUST** be disconnected on the carrier arm side and moved to the closed position prior to dropping the carrier to the ground. We recommend the use of a small flat head screw driver.

## Warranty Information:

Your Tire Carrier is backed by a Lifetime Warranty on all structural parts including the Carrier A-Frame, Catch Mount, Pivot Bracket, Spindle Mount, Support Rod and License Plate Bracket.

The Powder Coated finish is backed by our 3 year 36,000 mile warranty. Care must be taken for the powder coated finish and should be treated similar to your vehicle paint finish to ensure a lifetime of trouble-free use.

Your Carrier rotates on two high quality bearings. The bearings are covered under our 3 year 36,000 mile warranty. At every 3,000 miles or six months, you will need to check operation of the bearings and grease if needed.

## Tools Needed for installation:

Standard Socket and Wrench Set  
Metric Socket and Wrench Set  
Allen Set  
Rivet Gun  
Small File  
1/8" Drill

Phillips Screwdriver  
Flathead Screwdriver  
Wire Cutters  
Wire Crimpers  
Rubber Mallet  
Torque Wrench



**Parts List:**

1. 1-A-Arm
  2. 1- Catch Bracket (Left Side Mount)
  3. 1-Rubber Dampening Pad
  4. 1-Plastic lifter block with 2 screws
  5. 1- Spindle Mount (Right Hand Mount)
  6. 1- Pivot Bracket (Hinge Piece)
  7. 1- Support Rod
  8. 1- Heavy Duty License Plate Bracket
  9. 1- License Plate Light
  10. 1- Wiring Kit (4' wire, 1 tap, 1 butt connector, 1 flex tube)
  11. 1- Cap (top of Pivot Bracket)
  12. 2- Rivets (aluminum)
  13. 2- Races
  14. 2- Bearings
  15. 1- Bearing washer
  16. 1- Cotter Pin
  17. 1- Bearing Nut
  18. 1-Seal
  19. 3- Lug Nuts 14mm
  20. 2- Stainless Steel Dome 1/2" Bolts with Small lock nuts
  21. 2- Stainless Steel Washers for upper Rod Support Mount
  22. 1- Jack Relocating Mount with bolt/ny-lock/washer
  23. 1- Interior Panel Plug Kit (1 black plastic interior plug and 1 short stainless filler bolt)
  24. 1- Heim/Rod End with 1/2" Stainless Nut
  25. 1- Stainless Steel 1/2" Push Pin
  25. 1- Locking Latch inc. 2 keys
  27. 2- 1/4"-20 Stainless Dome License Plate Bolts with Stainless Ny-Locks
  28. 1- Security Latch
  29. 1- Security Latch 1/4-20x5/8" Allen Head Bolt w/Washer and Ny-Lock Nut.
- Optional Opening Assist
28. 1- Hydraulic Ram
  29. 2- Ball Studs



**Exterior Parts Diagram (excluding opening assist):**

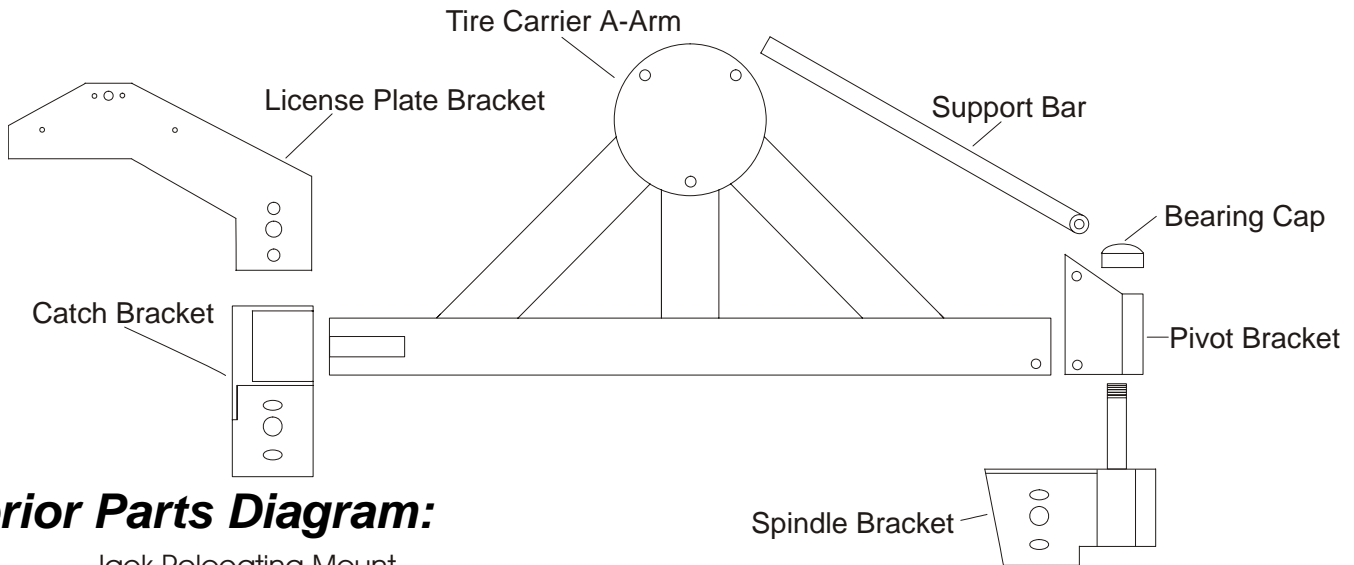

**Interior Parts Diagram:**



## Installation Procedure:

- 1 Remove Spare Tire from the interior of your H2.
- 2 Remove Interior Spare Tire Mount. Reinstall all bolts back into the body to fill the holes except for the bolt located on the vertical rear door pillar and bolt/spacer located just above the storage tray.
- 3 Discard bolt and spacer used on rear door panel previously left open. Install supplied shorter bolt and Panel Plug. Note, some vehicles require the use of a small drop of silicone on the interior side of the panel plug to help retain in place.
- 4 After removing your interior Tire Mount you will be left with a loose Jack. Using the supplied Jack Relocating Mount, install mount with short side attached to drivers side of H2. Use existing bolt and spacer with spacer located on the back side of the mount spacing mount out to the proper distance. Attach top of Jack Mount to long side of the Jack Relocating mount with supplied bolt and nylock.
- 5 Clean off powder coat from the inside of both upper light mount holes and the inside of the two lower bumper mounting holes of the License Plate Bracket. This will be used to ground the light to the vehicle. Your other option is to run a second ground line connecting the light ground, located on the interior of the light housing to a common vehicle ground. The light ground is the metallic base of the light with the two attachment holes on either side of the wiring harness.
- 6 From the front side of the License Plate Bracket, rivet License Plate Light after removing the clear lens from the light to License Plate Bracket with supplied rivets. Make sure there is a metal to metal contact by cleaning off part of the powder coating on the mounting holes of the bracket as in step one. This is important for a secure electrical ground.
- 7 Attach the Black Plastic Rest, with wedge side out, on Catch Bracket with supplied screws. Attach Rubber Dampening Pad to the inside vertical side of the Catch Bracket, just above the Plastic Rest. The Plastic Rest will be used to relieve the weight of the Tire Carrier while the Rubber Dampener will allow the A-Arm to fully rest on the inside of the Catch Bracket.
- 8 Remove both D-Rings Tow Loops from rear bumper by removing the two factory supplied M12x55 bolts on each D-Ring.
- 9 Mount Spindle Bracket to right hand side of the bumper. Use existing hardware and D-Ring.
- 10 Install Catch Mount with License Plate Bracket on the back side, to drivers side D-Ring mount with stock hardware and D-Ring. Leave slightly loose.
- 11 Pre-Grease bearings and install into the pivot bracket and loosely attach to spindle bracket. Be sure to install races on opposite sides of spindle bracket facing each other. Bearings will then slide into place, one from the top and the other from the bottom. Slide Seal onto Spindle Bracket and slide Pivot Bracket onto Spindle Bracket. Install washer and nut. Tighten nut and install cotter pin. See figure below.

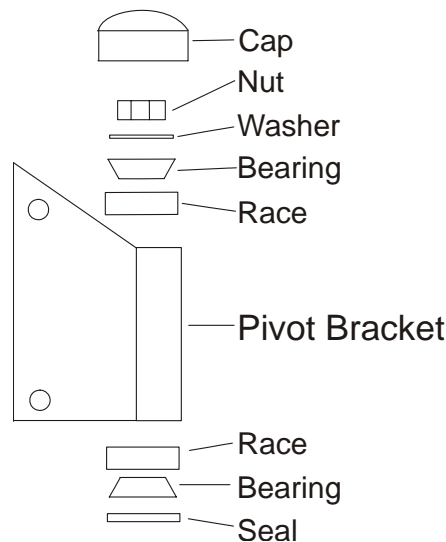

- 12 Attach A-Arm to lower Pivot Mount hole using supplied Dome Bolts and Washers. Washers are to be mounted on the inside of the Pivot Mount on either side of the A-Arm. Tighten.
- 13 Attach Support Bar with supplied dome bolt in the upper Pivot Mount hole. Tighten.
- 14 Loosely install Rod End with Locking Nut. Do not tighten Locking Nut.

- 15 Install .5" Stainless Push Pin through A-Arm mounts and Rod End. This will take several minutes to adjust the position of the A-Arm to the catch plate by turning Rod End in or out depending on your position.
- 16 Adjust Catch Plate in or out to create no more than a .25" gap between Catch Plate and end of A-arm. Tighten Catch Plate bolts while maintaining a level License Plate Bracket.
- 17 Torque all four D-Ring bolts to 80 foot-pounds.
- 18 Pull Stainless Push Pin and drop Carrier Arm to the ground. Attach tire to carrier and tighten using supplied lug nuts.
- 19 Lift Carrier arm and slide Pin back into place through rod end.
- 20 Swing closed and check for alignment. It is recommended to have the carrier Arm slightly resting on the Plastic Rest however this is not necessary. Use the supplied nut on Rod End, lock in place.
- 21 Grease Pivot Bracket housing with grease gun. Apply a small amount of grease to Stainless Pin.
- 22 Install Bearing Cap. It may be necessary to use a rubber mallet and a soft rag to lightly tap the cap into place.
- 23 Route wire from License Plate Light through bumper. Hint: You can route the wire through the bumper by drilling a 1/8" hole through the plastic bumper end cap or by simply routing between the end cap and steel bumper corner.
- 23 Locate trailer wiring harness and follow forward to the vehicle wiring harness. Locate label on wire (wire color should be brown) reading "park lights". Connect License Plate Light wire to this wire using supplied tap. Check lights for proper function.
- 24 Install Secondary latch bracket onto catch bracket with supplied 1/4" x5/8" Stainless Steel Bolt and Washer. When mounting insert washer between face plate of catch bracket and latch. See Figure 1 below.

## Optional Opening Assist

- 25 Install the two ball studs into the bottom side of the carrier a-arm and one in the bottom side of the pivot bracket. Tighten. Note: Some cases powder coat can flow into the beginning part of the threads. This needs to be cleaned out and care taken when installing the studs in order to not damage the treads.
- 26 Install hydraulic opening assist arm onto the two studs with the hydraulic cylinder side mounted closest to the pivot bracket. The ends of the ram will clip over the ball studs. You may need to use a small flat head screwdriver to open the clips to install. See Figure 2 below.



Fig. 1



Fig. 2



**Optional Opening Assist Diagram**

**IMPORTANT: The carrier arm can not be lowered into the down position when the opening assist is attached. Please remove one side to lower into the dropped position.**

## Now Available

Along with owning the most advanced tire carrier you can now complete the interior of your H2 with our Jack Cover. Available through your authorized Predator Motorsports Dealer.

