



PRODUCT NUMBER
H2-EXT-625 /-B

BILLET DOOR BUCKETS INSTRUCTION MANUAL

Congratulations on the purchase of your new accessory by Predator. As with all products, proper installation is the key to obtaining all of the benefits your accessory is capable of delivering. Please take a few minutes to read through the instructions to identify the components and learn where and how they are used. It is a good idea to start by comparing the parts in your kit with the parts list below. Be sure to take all applicable safety precautions during the installation of this product.



<u>Parts List</u>	<u>Quantity</u>	<u>Tools Required</u>	
Front Left Door Bucket	1	• 7mm socket	• Needle Nose Pliers
Front Right Door Bucket	1	• 10mm socket	• Panel Popper
Rear Left Door Bucket	1	• Phillips Head	• Allen Wrench Set
Rear Right Door Bucket	1		

Front Door Buckets

Removal Procedure

1. Remove Door Trim Panel.
2. Remove the window switch from the door trim panel, and plug back into door harness.
3. Pull back the plastic inner panel to gain access to the window regulator and door handle.
4. Raise window to the closed position so you can access the 10mm nuts (1) securing the window to the regulator. Loosen the nuts.
5. Remove the weather-strip from bottom of window frame.
6. Remove window glass from door by lowering window until glass can be lifted out of opening.
7. Disconnect outside door handle rod (1) by releasing retaining clip (2).

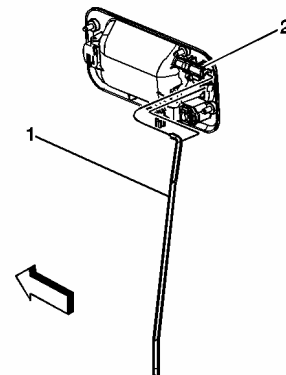
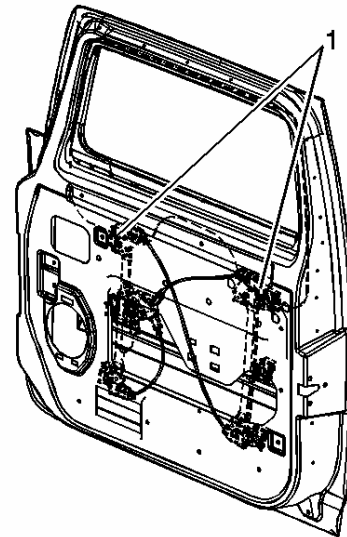

8. Disconnect lock cylinder rod by releasing retainer clip (1).

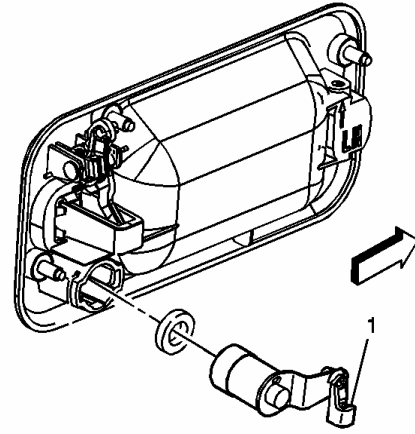

9. Apply tape to outside of Door Handle to hold in place while removing
10. Attaching fasteners.
11. Remove 3 fasteners retaining door handle.
12. Remove door handle.

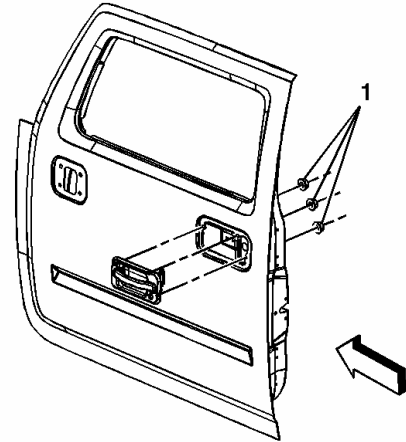

Transferring Parts Procedure

1. Remove bell crank pivot pin and bell crank. Use caution when removing spring and note orientation of crank and spring for reinstallation.
2. Remove Handle Pivot Pin by drilling/grinding staked portion and discard pin.

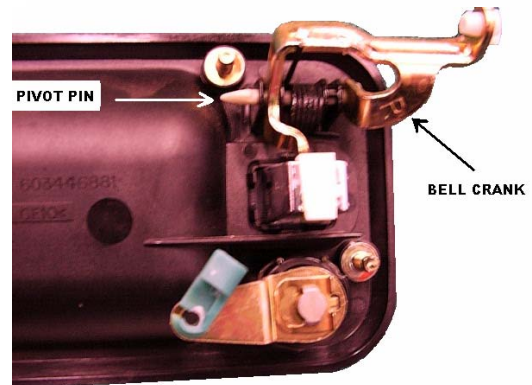

3. Remove rectangular bezel from original door handle.

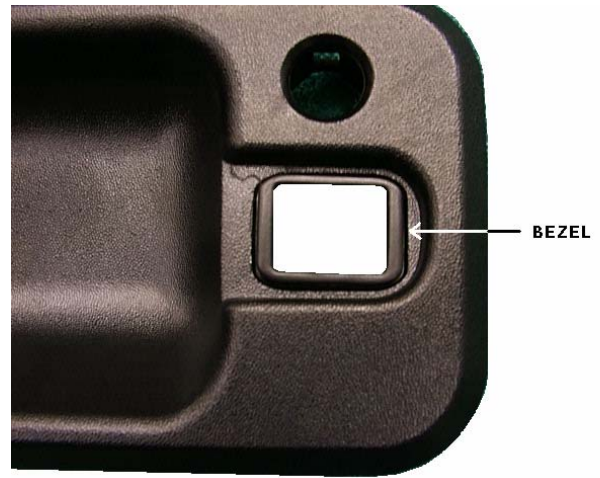

4. Remove Lock cylinder from original door handle by removing retaining clip (1).

To aid in removing the lock cylinder, a heat source such as a heat gun or butane torch may be necessary. Use **EXTREME** caution when heating plastic around cylinder not to melt plastic or damage cylinder.

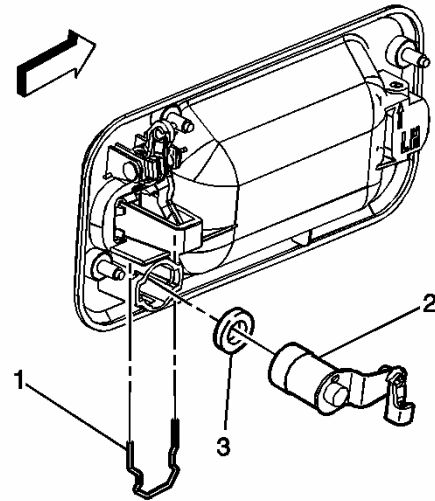

5. Install Lock Cylinder by reversing procedure above.
6. Install bezel from step 3.
7. Install pull handle from step 2 using supplied pivot pin into new handle.
8. Install bell crank, spring and pivot pin from step 1 noting original orientation.

Installation Procedure

1. Place the door handle in the door opening.
2. Install lock cylinder rod by fastening retainer clip.
3. Install door handle rod by fastening retainer clip.
4. Secure door handle using the original mounting nuts and tighten to 7 ft/lbs.
5. Operate door handle to ensure proper operation.
6. Install window glass
7. Raise window until it is completely closed.
8. Tighten the clamps (1) securing the window to the window module.
9. Replace the rear vertical window channel.
10. Unplug the window switch.
11. Re-attach the plastic inner panel.
12. Replace the window switch in the door trim panel.
13. Install trim panel.

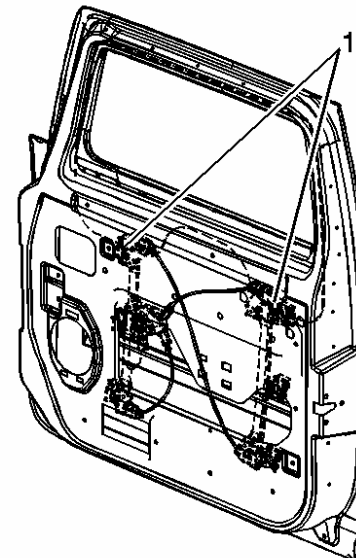

Rear Door Buckets

Note: it is not necessary to remove window glass on rear doors

Removal Procedure

1. Remove Door Trim Panel.
2. Remove Plastic inner panel.
3. Disconnect outside door handle rod (1) by releasing retaining clip (2).

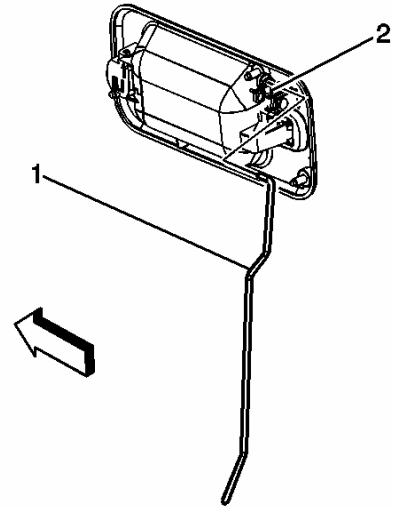

4. Remove 3 fasteners retaining door handle.
5. Remove door handle.

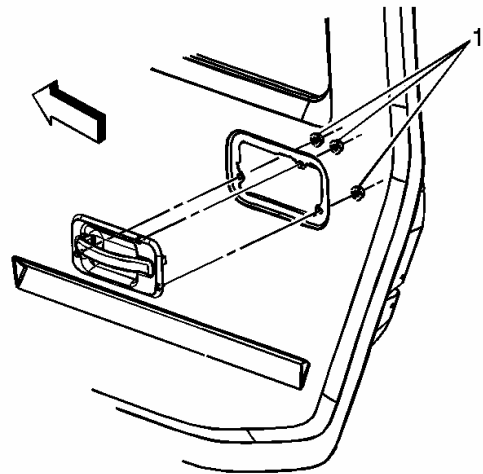

Transferring Parts Procedure

1. Remove bell crank pivot pin and bell crank. Use caution when removing spring and note orientation of crank and spring for reinstallation.

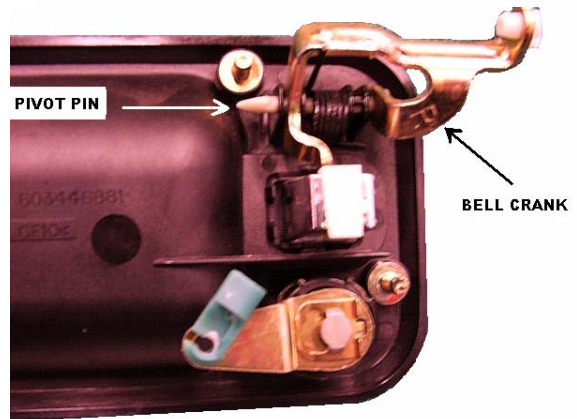

2. Remove Handle Pivot Pin by drilling/grinding staked portion and discard pin.



HANDLE PIVOT PIN

3. Remove rectangular bezel from original door handle.



BEZEL

4. Install bezel from step 3.
5. Install pull handle from step 2 using supplied pivot pin into new handle.
6. Install bell crank, spring and pivot pin from step 1 noting original orientation.

Installation Procedure

1. Install handle using three original fasteners (torque to 7 ftlbs).
2. Install door handle rod by fastening retainer clip.
3. Operate door handle to ensure proper operation.
4. Install Plastic inner panel.
5. Install door trim panel.

