



1250 Distribution Way, Vista Ca 92081  
Phone: 760-734-1749 Fax: 760-874-2973

# H 1 TIRE CARRIER INSTRUCTIONS

## Product Information:

Thank you for your recent purchase of your new Tire Carrier. You now own the finest Tire Carrier on the market.

**IMPORTANT:** To ensure proper function and safety, you **MUST** completely push latch in until it clicks and latches closed. Note: When properly closed, latch handle will remain perfectly flush in housing with release button/lock exposed. Failure to do so will void warranty and possibly cause injury. Predator Motorsports will not be liable for misuse.

The entire carrier pivots on a proven bearing system rated at 2000 lbs, which will guarantee smooth operation. This system will need to be greased and inspected every 3,000 miles.

Incorporated into the design is a drop-down feature, which aids in relocating your tire to the ground in the event of a flat tire. Simply lift up on the carrier arm to relieve pressure on the Stainless Push Pin and pull the pin. Slowly drop carrier arm to the ground. When locating carrier arm back into the vertical position care must be taken not to move the support rod. If the support rod is moved you will need to take several moments to relocate the support rod end back into the original position for proper alignment of the pin. If your carrier is equipped with the optional Opening Assist, the hydraulic ram **MUST** be disconnected on the carrier arm side and moved to the closed position prior to dropping the carrier to the ground. We recommend the use of a small flat head screw driver.

## Warranty Information:

Your Tire Carrier is backed by a Lifetime Warranty on all structural parts including the Carrier A-Frame, Catch Mount, Pivot Bracket, Spindle Mount, Support Rod and License Plate Bracket.

The Powder Coated finish is backed by our 3 year 36,000 mile warranty. Care must be taken for the powder coated finish and should be treated similar to your vehicle paint finish to ensure a lifetime of trouble-free use.

Your Carrier rotates on two high quality bearings. The bearings are covered under our 3 year 36,000 mile warranty. At every 3,000 miles or six months, you will need to check operation of the bearings and grease if needed.

## Tools Needed for installation:

Standard Socket and Wrench Set  
Metric Socket and Wrench Set  
Allen Set  
Rivet Gun  
Small File  
1/8" Drill

Phillips Screwdriver  
Flathead Screwdriver  
Wire Cutters  
Wire Crimpers  
Rubber Mallet  
Torque Wrench





## Parts List:

1. 1-A-Arm
  2. 1- Catch Bracket (Left Side Mount)
  3. 1-Rubber Dampening Pad
  4. 1-Plastic lifter block with 2 screws
  5. 1- Spindle Mount (Right Hand Mount)
  6. 1- Pivot Bracket (Hinge Piece)
  7. 1- Support Rod
  8. 1- Cover Plate for Catch Bracket
  9. 1- Cover Plate for Spindle Bracket
  10. 1- Cap (top of Pivot Bracket)
  11. 2- Races
  12. 2- Bearings
  13. 1- Bearing washer
  14. 1- Cotter Pin
  15. 1- Bearing Nut
  16. 1-Seal
  17. 3- Lug Nuts 9/16"
  18. 2- Stainless Steel Dome 1/2" Bolts with Small lock nuts
  19. 2- Stainless Steel Washers for upper Rod Support Mount
  20. 1- Heim/Rod End with 1/2" Stainless Nut
  21. 2- Stainless Steel 1/2" Push Pin
  22. 1- Locking Latch inc. 2 keys
  23. 6- 1/4"-20 Stainless Dome Bolts (used with cover plates)
  24. 4- 1/2" x4" bolts w/nuts
- Optional Opening Assist
28. 1- Hydraulic Ram
  29. 2- Ball Studs

## Exterior Parts Diagram (excluding opening assist):

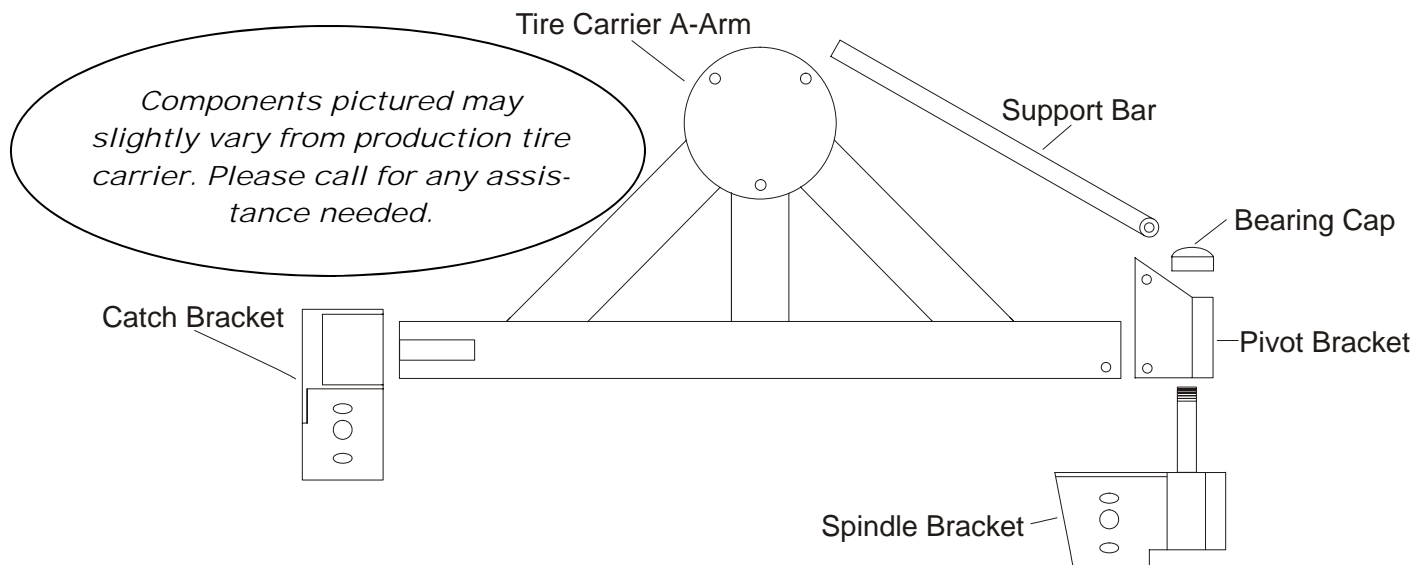



## Installation Procedure:

- 1 Attach the Black Plastic Rest, with wedge side out, on Catch Bracket with supplied screws. Attach Rubber Dampening Pad to the inside vertical side of the Catch Bracket, just above the Plastic Rest. The Plastic Rest will be used to relieve the weight of the Tire Carrier while the Rubber Dampener will allow the A-Arm to fully rest on the inside of the Catch Bracket.
- 2 Remove two bumper/frame mounting bolts on right hand side of left tow loop from rear bumper.
- 3 Loosely mount Spindle Bracket to right hand side of the bumper on existing 4 holes.
- 4 Install Catch Mount to drivers side mount with supplied longer hardware and washer plate. Leave slightly loose.
- 5 Pre-Grease bearings and install into the pivot bracket and loosely attach to spindle bracket. Be sure to install races on opposite sides of spindle bracket facing each other. Bearings will then slide into place, one from the top and the other from the bottom. Slide Seal onto Spindle Bracket and slide Pivot Bracket onto Spindle Bracket. Install washer and nut. Tighten nut and install cotter pin. See figure below.

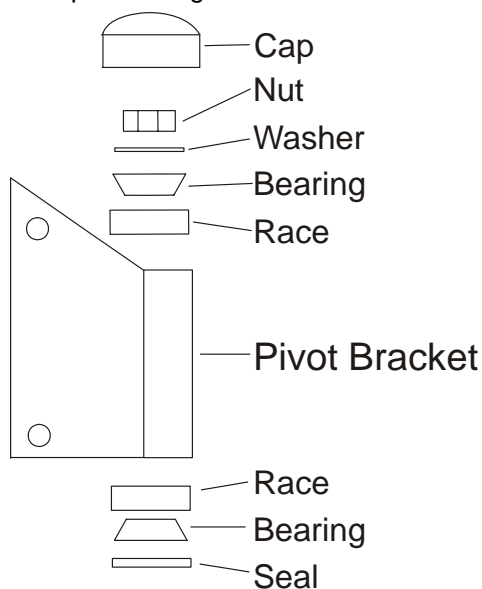

- 6 Attach A-Arm to lower Pivot Mount hole using supplied Dome Bolts and Washers. Washers are to be mounted on the inside of the Pivot Mount on either side of the A-Arm. Tighten.
- 7 Attach Support Bar with supplied dome bolt in the upper Pivot Mount hole. Tighten.
- 8 Loosely install Rod End with Locking Nut. Do not tighten Locking Nut.



- 9 Install .5" Stainless Push Pin through A-Arm mounts and Rod End. This will take several minutes to adjust the position of the A-Arm to the catch plate by turning Rod End in our out depending on your position.
- 10 Install Latch into tire carrier a-frame and loosen compression bolt for adjustment in step 13.
- 11 Adjust Catch Plate in or out to create no more then a .25" gap between Catch Plate and end of A-arm with secondary safety pin installed. Tighten Catch Plate bolts.
- 12 Torque all six tire carrier mounting bolts to 80 foot-pounds.
- 13 Adjust compression latch bolt in our out to add compression when latched closed.
- 14 Pull Stainless Push Pin and drop Carrier Arm to the ground. Attach tire to carrier and tighten using supplied lug nuts.
- 15 Lift Carrier arm and slide Pin back into place through rod end.
- 16 Swing closed and check for alignment. It is recommended to have the carrier Arm slightly resting on the Plastic Rest however this is not necessary. Use the supplied nut on Rod End, lock in place.
- 17 Grease Pivot Bracket housing with grease gun. Apply a small amount of grease to Stainless Pin.
- 18 Install Bearing Cap. It may be necessary to use a rubber mallet and a soft rag to lightly tap the cap into place.

## ***Optional Opening Assist***

- 19 Install the two ball studs into the bottom side of the carrier a-arm and one in the bottom side of the pivot bracket. Tighten. Note: Some cases powder coat can flow into the beginning part of the threads. This needs to be cleaned out and care taken when installing the studs in order to not damage the treads.
- 20 Install hydraulic opening assist arm onto the two studs with the hydraulic cylinder side mounted closest to the pivot bracket. The ends of the ram will clip over the ball studs. You may need to use a small flat head screwdriver to open the clips to install. See Figure 1 below.

Fig. 1



***Optional Opening Assist Diagram***

***IMPORTANT: The carrier arm can not be lowered into the down position when the opening assist is attached. Please remove one side to lower into the dropped position.***

